



**Dorset
Council**

Wildlife and Countryside Act 1981

Dorset Council

County of Dorset Definitive Map and Statement of Rights of Way

**Dorset Council (Part of Footpath 85, Weymouth)
Definitive Map and Statement Modification Order 2022**

This Order is made by Dorset Council under section 53(2)(b) of the Wildlife and Countryside Act 1981 ("the Act") because it appears to that authority that the County of Dorset Definitive Map and Statement require modification in consequence of the occurrence of an event specified in section 53(3)(c)(i) namely, that a right of way which is not shown in the map and statement subsists or is reasonably alleged to subsist over land in the area to which the map relates and section 53(3)(c)(iii) namely, that there is no public right of way over land shown in the map and statement as highway of any description or that any other particulars contained in the map and statement require modification.

The authority have consulted with every local authority whose area includes the land to which the Order relates. Dorset Council hereby order that:

1. For the purposes of this Order the relevant date is 23 June 2022.
2. The County of Dorset Definitive Map and Statement shall be modified as described in Part I and Part II of the Schedule and shown on the map attached to the Order.
3. This Order shall take effect on the date it is confirmed and may be cited as the "Dorset Council (Part of Footpath 85, Weymouth) Definitive Map and Statement Modification Order 2022".

Dated this 4TH day of NOVEMBER 2022

THE COMMON SEAL OF
DORSET COUNCIL
was fixed in the presence of:-

A handwritten signature in blue ink, appearing to be 'R. B. Smith'.

604/22



Authorised Signatory

The foregoing Order is hereby confirmed unopposed

A handwritten signature in black ink, appearing to be 'Jonathan Hui'.

Authorised Signatory

Dated this 27TH day of JANUARY 2023

SCHEDULE

(The points specified relate to the map attached to the Order and their positions are identified by national grid references)

Part I

Modification of definitive map Description of path to be deleted

Part of Footpath 85, Weymouth:

- A – B – C The whole width of the footpath from the unaffected part of Footpath 85, at
– D the private road, north of Manor Stables at point A (SY 66738424), south east
 across fields to the garden boundary of 735 Dorchester Road at point B (SY
 66858407) and continuing south east through the gardens of 735-731
 Dorchester Road to point C (SY 66878404), then east south east through the
 property 731 Dorchester Road to point D (SY 66898404). (No recorded
 width).

Description of path to be added

Part of Footpath 85, Weymouth:

- A – E – F From the unaffected part of Footpath 85, at the private road, north of Manor
– G – H – Stables at point A (SY 66738424), south south west along the road to point E
I (SY 66728420), then turning east along a stone surfaced path, passing to the
 south of Manor Stables to point F (SY 66758420) and continuing east and
 south east across a field to the south eastern corner of the field at point G (SY
 66848407). It continues south south east and south, along an earth and stone
 surfaced path to point H (SY 66858405), then east south east, passing
 between properties 731 and 729 Dorchester Road to its junction with
 Dorchester Road at point I (SY 66918403). The width varies: 2 metres
 between points A (SY 66738424) and G (SY 66848407) (except for 85cm at
 point F (SY 66758420)), 90 cm at point G (SY 66848407), 1 metre between
 points G (SY 66848407) and H (SY 66858405), 1.45 metres between points H
 (SY 66858405) and I (SY 66918403) and 75 cm at point I (SY 66918403).
 Limitations: Kissing gate at point G (SY 66848407), gap at point I (SY
 66918403).

Part II

Modification of definitive statement Variation of particulars of path

Footpath 85, Weymouth:

Delete:

From: 667842 To: 669840

Stottingway Street south eastwards to Dorchester Road (between Nos 729 and 733).

Add:

From: SY 667842

To: SY 66918403

Stottingway Street south along the private road, north of Manor Stables to SY 66738424, south south west along the road to SY 66728420, then turning east along a stone surfaced path, passing to the south of Manor Stables to SY 66758420 and continuing east and south east across a field to the south eastern corner of the field at SY 66848407. It continues south south east and south, along an earth and stone surfaced path to SY 66858405, then east south east, passing between properties 731 and 729 Dorchester Road to its junction with Dorchester Road. The width varies: 2 metres between points SY 66738424 and SY 66848407 (except for 85cm at SY 66758420), 90 cm at SY 66848407, 1 metre between SY 66848407 and SY 66858405, 1.45 metres between SY 66858405 and SY 66918403 and 75cm at SY 66918403. Limitations: Kissing gate at SY 66848407, gap at SY 66918403.

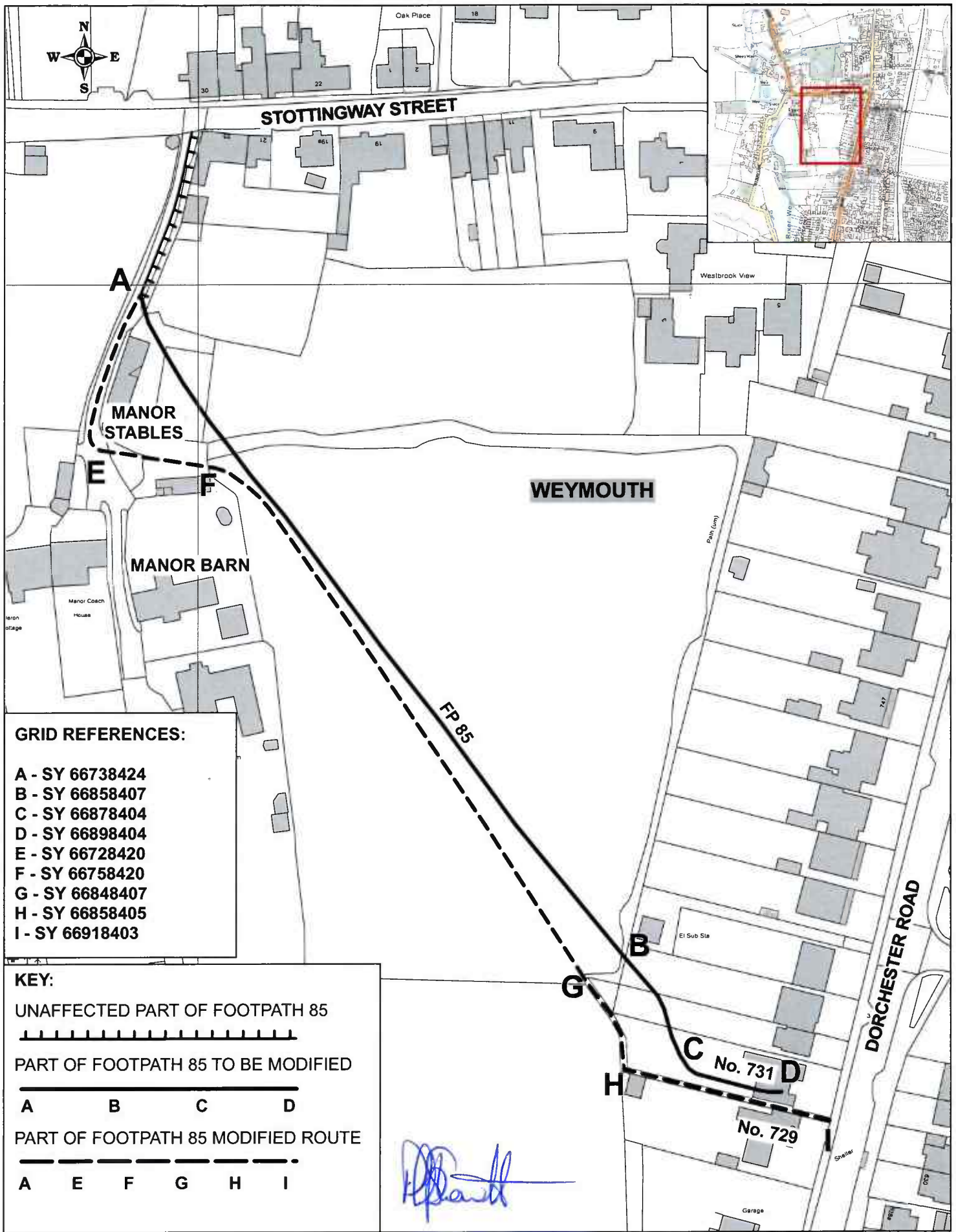

GRID REFERENCES:

- A - SY 66738424
- B - SY 66858407
- C - SY 66878404
- D - SY 66898404
- E - SY 66728420
- F - SY 66758420
- G - SY 66848407
- H - SY 66858405
- I - SY 66918403

KEY:

UNAFFECTED PART OF FOOTPATH 85



PART OF FOOTPATH 85 TO BE MODIFIED



PART OF FOOTPATH 85 MODIFIED ROUTE

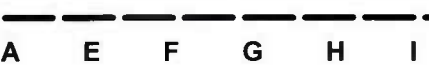

**DORSET COUNCIL (PART OF FOOTPATH 85, WEYMOUTH)
DEFINITIVE MAP AND STATEMENT MODIFICATION ORDER
2022**

Ref: T579/22/1
Date: 02/11/2022
Drawn by: KJS
Scale: 1:1250
Cent X: 366,822
Cent Y: 84,165



© Crown copyright and database rights 2022
 OS 0100060963. Aerial Photography ©
 UK Perspectives 2002 & © Getmapping 2005, 2009
 & 2014, © Getmapping Plc and Bluesky International
 Limited (2017 onwards)